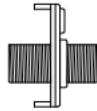
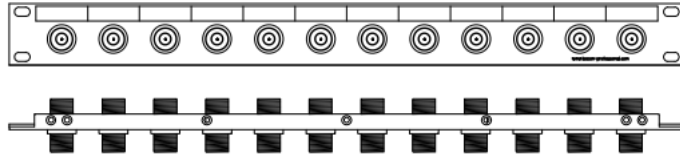

Datasheet:**Becom_1HU_PP****RAL7035_Nf_Nf****50_12_18GHz_HS****beCom****Description:**

The 12-port patch panel with N-female to N-female connectors offers several advantages over conventional patch panels. The sockets are mounted in specially milled mounting holes, which, together with the locknut, ensures protection against twisting of the socket when cables are connected. The easily replaceable labeling strip can be printed using a downloadable Excel file to ensure clear identification of the sockets. An optional strain relief bar, which is mounted at the rear of the patch panel, is available to ensure that the cables are strain-relieved and can be neatly bundled.

Technical Data:**Color:** RAL 7035 Light Grey**Dimensions:** 483 x 44 x 40 mm**Equipped with:** 12 pcs. Huber Suhner 34_N-50-0-1/133_N**Weight:** 756g**Material:**

- Inner contact: Copper/Beryllium alloy
- Outer contact: Brass

Electrical Data:**Impedance:** 50 Ω **Interface Frequency Max:** 18 GHz**VSWR:**

- DC to 12.4 GHz: $\leq 1.06 + 0.17 f \text{ (GHz)}$